

# OPERATION-LUBRICATION-CARE

# MOTOR ASSEMBLY & ACCESSORIES

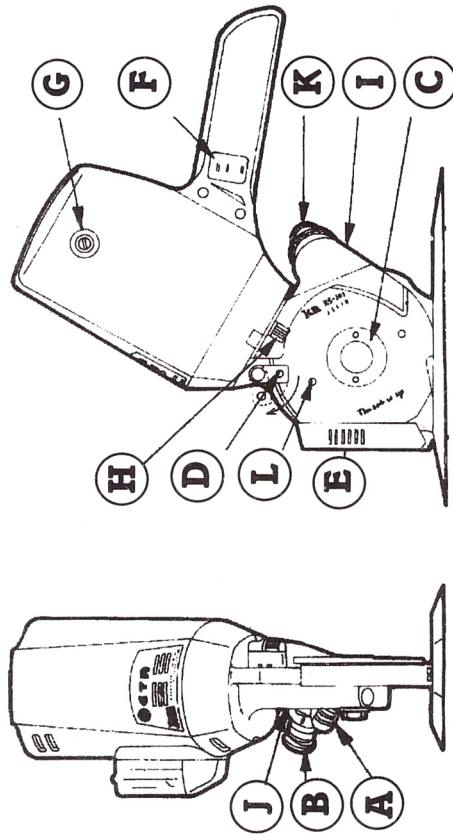

# STANDARD & BASE ASSEMBLY

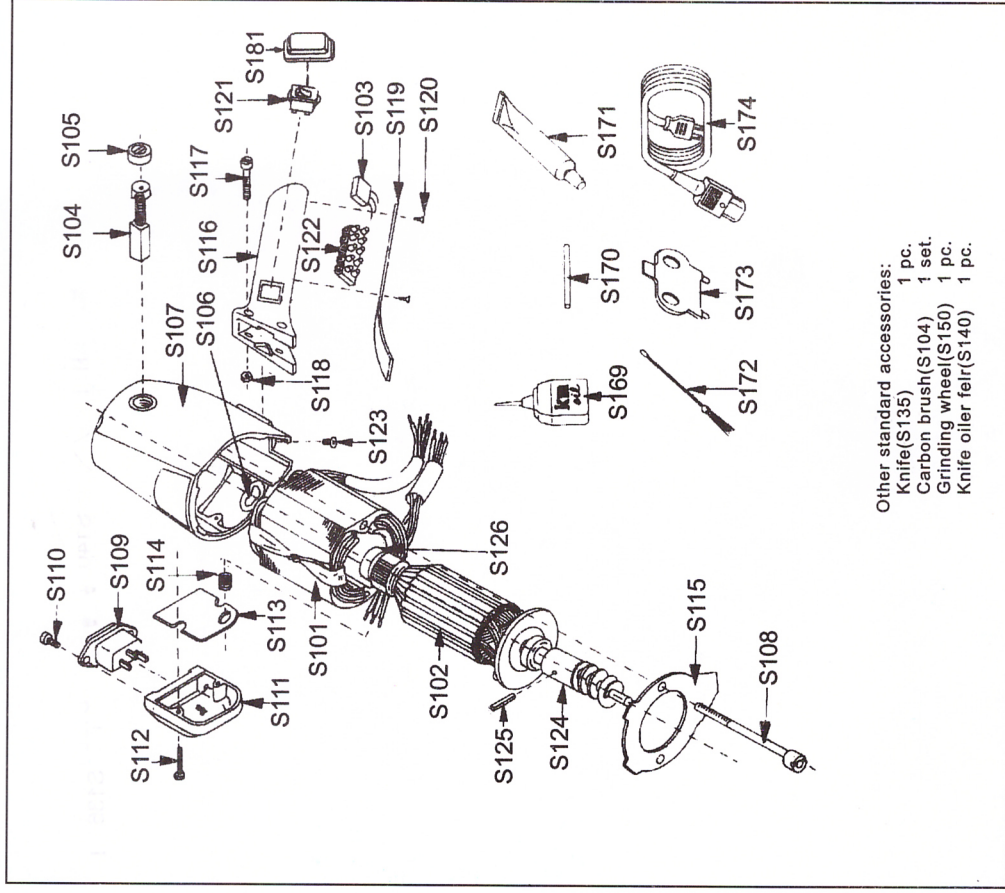
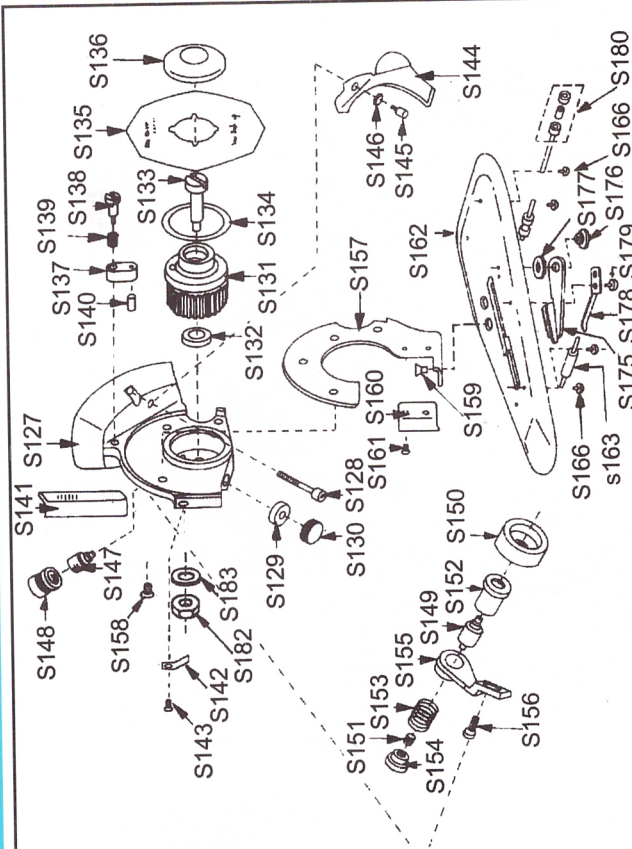

PART NO.	PART NAME	PART NO.	PART NAME
S-101	Stator	S-112	Screw for T.BOX
S-102	Rotor	S-113	Terminal Plate
S-103	Condenser	S-114	Rubber Bushing
S-104	Carbon Brush	S-115	Air Guide
S-105	Cap for Carbon Brush	S-116	Drive Handle
S-106	Wave Washer	S-117	Screw for Handle
S-107	Motor Cover	S-118	Nut for Handle
S-108	Screw for stator	S-119	Cover for Handle
S-109	Terminal	S-120	Screw for Cover
S-110	Screw for Terminal	S-121	Switch
S-111	Terminal Box	S-122	Connecting Terminal

PART NO.	PART NAME	PART NO.	PART NAME
S-123	Screw for Earth	S-158	Screw for Standard (upside)
S-124	Drive Gear	S-159	Screw for Standard(bottom)
S-125	Roll Pin	S-160	Guide Plate
S-126	Bearing	S-161	Screw for Guide Plate
S-127	Gear Box	S-162	Base Plate
S-128	Screw for G.Box	S-163	Front Roller
S-129	Drive Gear Metal	S-164	Roller Shaft (front)
S-130	Cover for Metal	S-165	Roller Shaft(rear)
S-131	Knife Gear	S-166	Screw for Roller Shaft
S-132	Washer for Gear	S-169	Oiler
S-133	Screw for Gear	S-170	Lock Shaft
S-134	Ring for Gear	S-171	Grease
S-135	Knife (8-sided) ※ Round(option)	S-172	Cleaning Brush
S-136	Lock Nut for Knife	S-173	Wrench
S-137	Knife Oiler	S-174	Code Complete with earth
S-138	Screw for Oiler	S-175	Lower Blade
S-139	Spring for Oiler	S-176	Screw for Lower Blade
S-140	Oil Felt	S-177	Washer for Lower Blade
S-141	Knife Guard	S-178	Pressure Spring foe Lower Blad
S-142	Spring for Guard	S-179	Screw for Pressure Spring
S-143	Screw for Spring	S-180	Rear Roller Set
S-144	Safety Plate	S-181	Switch Cap
S-145	Screw for Plate	S-182	Nut for Knife Gear Screw
S-146	Spring Washer for Plate	S-183	Washer for knife Gear Screw
S-147	Grease Cup		
S-148	Cap for Grease Cup		
S-149	Grinder Shaft		
S-150	Emery Wheel		
S-151	Grinder Spring		
S-152	Grinder Collar		
S-153	Spring for collar		
S-154	Sharpening Switch		
S-155	Grinder Arm		
S-156	Screw for Grinder Arm		
S-157	Standard		