

1. 机体部件I/Body partsI

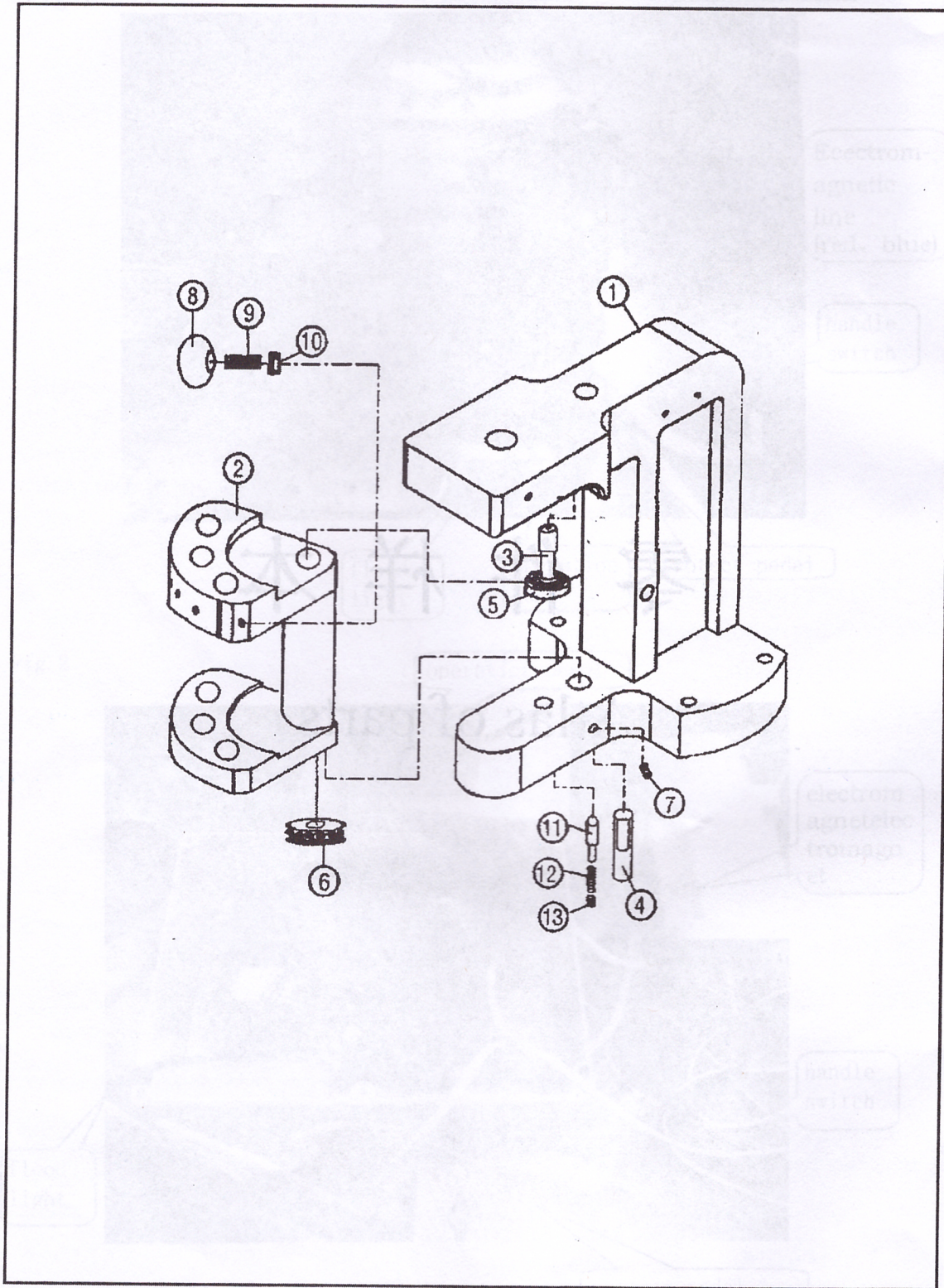

机体部件I/Body parts I

号	零件名称	NAME	零件编码	数量	备注
	机体	Body	70210001	1	
	摆动座	Adjusting link	70210002	1	
	摆动座上轴	Adjusting link upper shaft	70210003	1	
	摆动座下轴	Adjusting link lower shaft	70210004	1	
	摆动座上轴承	Upper Bearing	70210005	1	d=15
	摆动座下轴承	Lower Bearing	70210006	1	d=15
	摆动座内六角螺钉	Bolt	70210007	2	M8 L=8
	摆动座球型拉手	Bulb handle	70210008	2	
	摆动座球型拉手螺钉	Bulb Bolt	70210009	2	M8 L=25
	摆动座球型拉手螺母	Bulb Nut	70210010	2	
	摆动座定位销	Pin	70210011	1	
	定位销弹簧	Spring	70210012	1	
	定位销螺钉	Pin Bolt	70210013	1	M12 L=10

2. 机体部件II/Body partsII

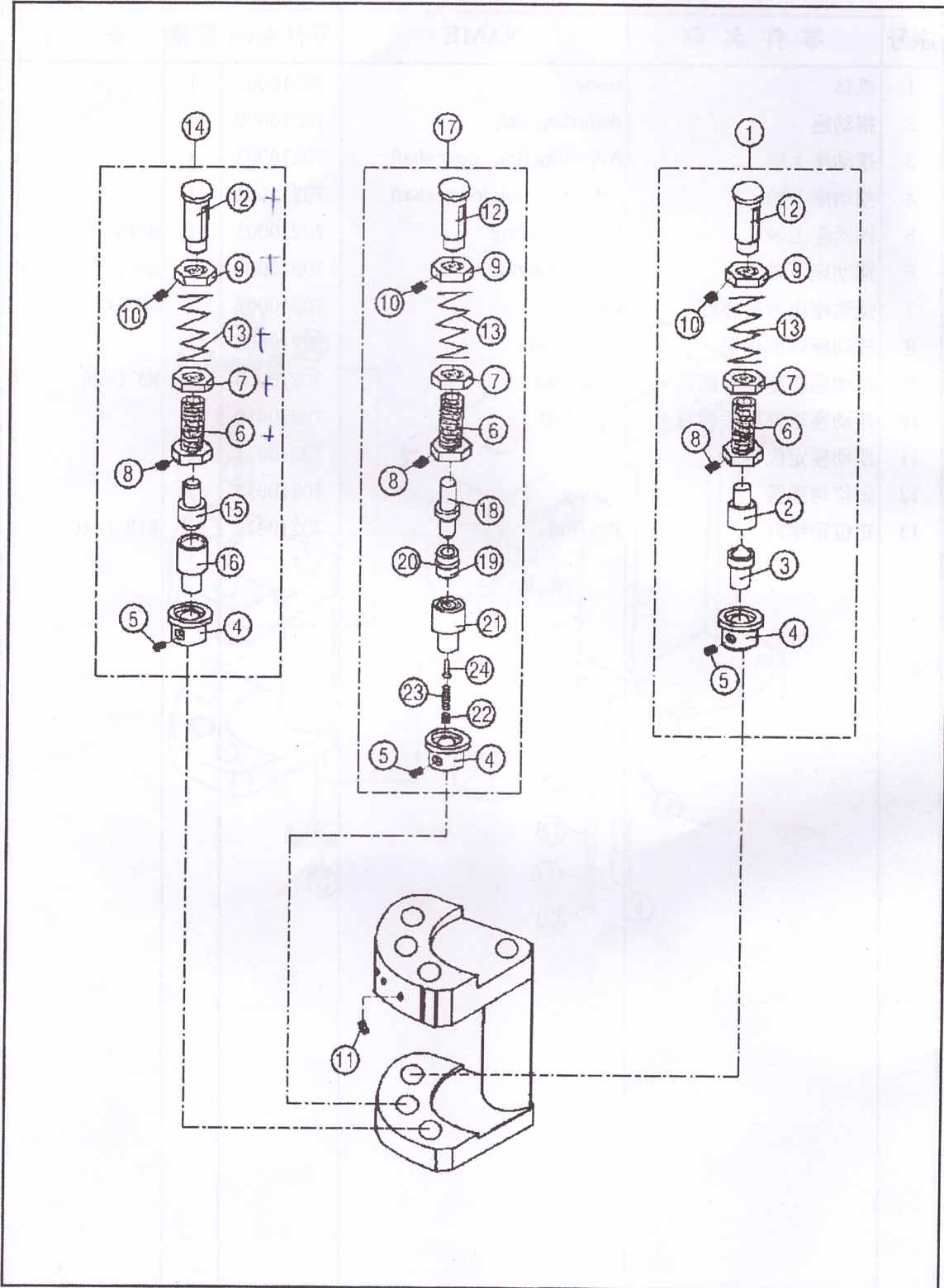

机体部件II/Body partsII

零件名称	Name	零件编码	数量	备注
冲模组件1	Punching mould assembly 1	70212000	1	
冲孔上模	Punching Upside mould	70212001	1	
冲孔下模	Punching downside mould	70212002	1	
下模套	Downside sheath	70212003	3	
下模套螺钉	Downside sheath screw	70212004	3	M6X15
上模调节螺柱	Adjusting bolt	70212005	3	
上模调节螺母	Adjusting nut	70212006	3	
上冲模螺柱螺钉	Bolt	70212007	3	M6X6
冲轴螺母	Die shaft nut	70212008	3	
冲轴螺母螺钉	screw	70212009	3	M5X4
冲模轴螺钉	Die shaft screw	70212010	6	M6X6
冲轴	Die shaft	70212011	3	
冲轴弹簧	Die shaft spring	70212012	3	
冲模组件2	Punching mould assembly 2	70213000	1	
上扣上模	Upside fastener up mould	70213001	1	
上扣下模	Upside fastener down mould	70213002	1	
冲模组件3	Punching mould assembly 3	70214000	1	
F扣上模	Downside fastener up mould	70214001	1	
F扣上模套	Mould sheath	70214002	1	
F扣上模套橡胶圈	Rubber band	70214003	1	
F扣下模	Downside fastener mould	70214004	1	
F扣下模螺钉	Downside fastener mould screw	70214005	1	M8X8
F扣下模定位销弹簧	Downside fastener mould spring	70214006	1	
F扣下模定位销	Downside fastener mould pin	70214007	1	

3-1. 电磁部件/Electromagnetic parts

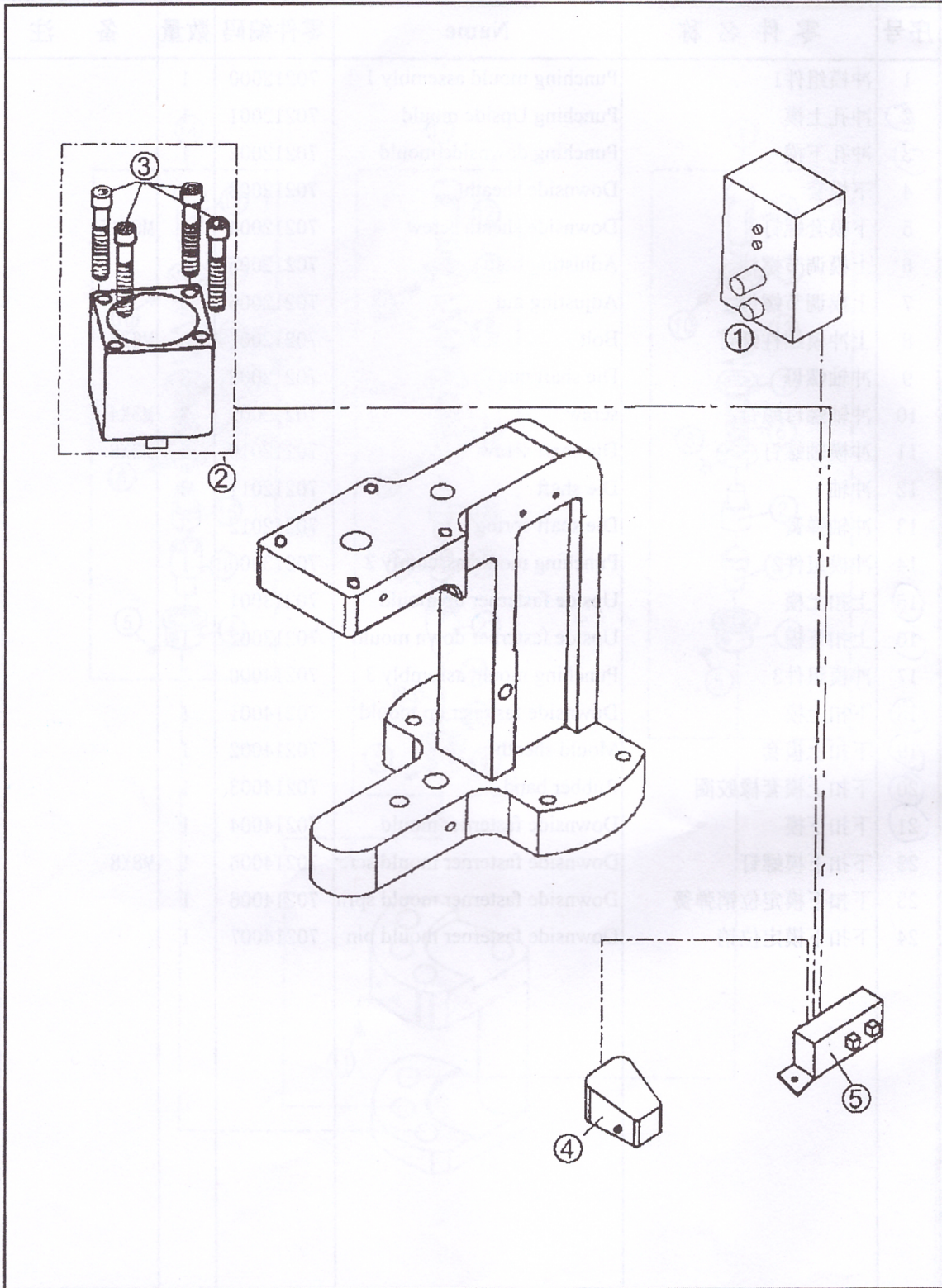

-1. 电磁部件/Electromagnetic parts

号	零件名称	NAME	零件编码	数量	备注
1	操作面板	Operation Panel	70224000	1	
2	电磁铁组件	Electromagnetic	70225000	1	
3	电磁铁安装螺钉	Electromagnetic setscrew	70220002	4	M8X78
4	行程开关组件	Switch assembly	70223000	1	
5	电源开关	Switch	70220004	1	

3-2. 气动部件/Pneumatic parts

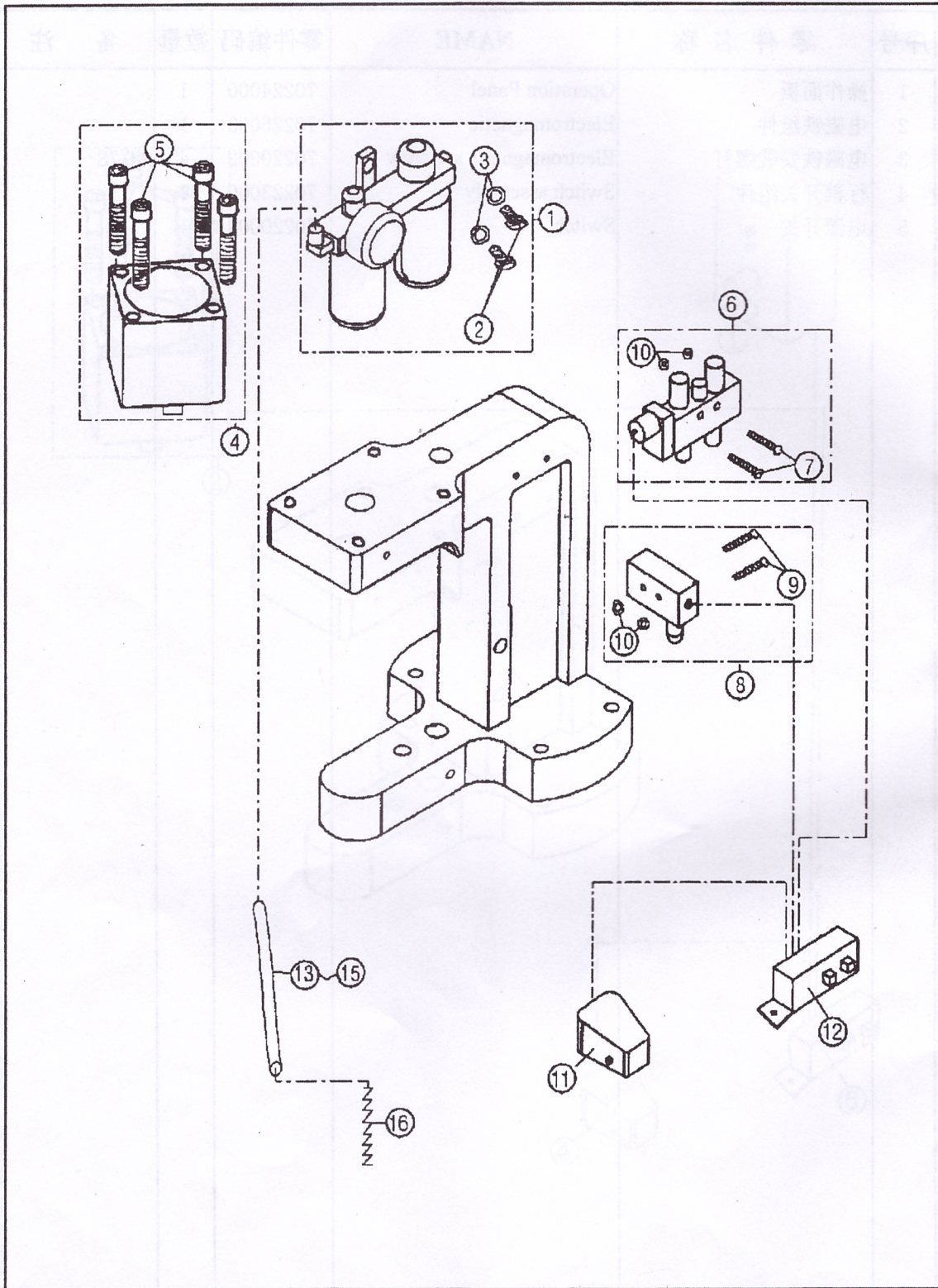

1. 气动部件/Pneumatic parts

零件名称	NAME	零件编码	数量	备注
空气压力表组件	Water and Oil segregator	70221000	1	
空气压力表内六角螺钉	Combination setscrew	70221001	2	M6X20
空气压力表垫圈	Combination attachment nut	70221002	2	D=4
压力气缸	Pressure Cylinder	70220001	1	
压力气缸内六角螺钉	Bolt	70220002	4	M8x78
电磁阀组件	Electromagnetic valve	70222000	1	
电磁阀螺钉	Electromagnetic valve setscrew	70222001	2	M4X35
消声器	Muffler	70222002	2	
直通快拧	Connector	70222003	3	
直通快拧	Connector	70222004	2	
行程开关组件	Switch assembly	70223000	1	
行程开关紧固螺钉	Bolt	70223001	2	M4X28
行程开关垫圈	Gasket	70223002	2	D=5
脚踏式开关	Pedal switch	70223003	1	
电源开关	Switch	70223004	1	
压缩空气橡胶软管(长)	Rubber tube(long)	70223005	1	
压缩空气橡胶软管(中)	Rubber tube(middle)	70223006	1	
压缩空气橡胶软管(短)	Rubber tube(short)	70223007	1	
压缩空气橡胶软管弹簧	Rubber tube spring	70223008	1	
绝缘管	Isolation pipe	70223009	3	
接线端头	Cable Terminal	70223010	3	
整流管	Stream regulatory pipe	70223011	1	
4.5V变压器	4.5V transformer	70223012	1	
行程开关螺母	Switch nut	70223013	2	M5
压缩空气输气橡胶软管	Rubber tube	70224000	1	